

Fire procedures

Make sure you know what to do

Fire action posters

When you are in a building, familiarise yourself with the information on the building Fire Action Notice. These will be located adjacent to fire alarm break glass call points.

University fire procedure

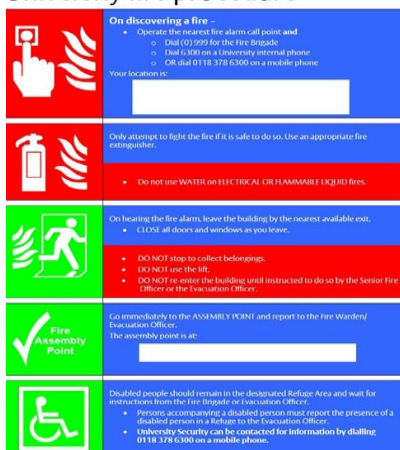

Fire Action Notice



Fire exit sign and wheelchair-friendly fire exit route sign



Fire alarms

- This building has a fire alarm system that incorporates automatic fire detection.
- A red break glass fire alarm call point is located at every staircase or external exit door.
- If you discover a fire and the fire alarm is not yet sounding, then raise the alarm by pressing the red break glass call point.
- The sound will be a voice alarm interspersed with a siren.
- Visual warning signals are provided which will be a strobe and sounder beacon.
- Digital messaging system is installed for deaf students, staff and visitors to download and use. Anyone can use it. Follow instructions at the end of this GEEP or on the entrance points of the building.



Fire alarm call point



Digital messaging system



Green emergency door release

Fire exits

- On hearing or seeing the fire alarm sounding make your way to the nearest available safe exit route and leave the building without delay.
- Swipe access doors on escape routes will automatically release on the activation of the fire alarm.
- A green break glass call point is located next to the swipe access door. Should the door not release press the middle of the green break glass call point and the door will release.

Fire assembly point

- Make your way to the designated fire assembly point. This will be identified in the building fire action notice.
- Do not re-enter the building.
- Wait at the assembly point until you are informed by the Evacuation Officer or University Security that it is safe to return to the building.



Disabled refuge

Disabled refuge

- This building has fire refuges.
- All refuges provide protection from fire and smoke for a minimum of 30 minutes and can be found on the exit routes in the fire exit staircase.
- If the fire alarm sounds you should move to a refuge.
- A member of the building fire evacuation team will return to you in the refuge until there is a need to be evacuated, or the all clear is given.
- While waiting in a refuge you may have a designated friend or carer stay with you in the refuge during the fire alarm activation.
- You will be assisted from the refuge on confirmation of a real fire. This is to avoid unnecessary stress upon you being evacuated due to a false alarm.
- An Escape chair and an Escape mattress is located in a nearby building.
- The University has trained staff to operate the evacuation lift, escape chair, and escape mattress.

Commend refuge
communications intercom

Staircase refuge

- Follow the instructions on the information poster in the refuge to summon assistance via the red Commend communications intercom.
- Press the button on the evacuation intercom in order to let Security know that you are in the refuge and may need assistance.



Escape Chair



Escape Mattress



Digital Messaging Service

To receive fire alert notifications for this location:

Please text the code

N9K21Y

to 07480 486966



or scan this QR code to register

Additional information

For more information scan the QR code or visit [Fire safety](#) and click on Policy, CoPs & Safety notes to look Safety Note 20 Evacuation of disabled persons, and Code of Practice 56 PEEPS.



**General fire safety
information or advice**
University Fire Safety Adviser

0118 378 8282

firesafety@reading.ac.uk

Please contact the University Fire Safety Advisor, school disability representative, if you need:

- assistance to familiarise yourself with the evacuation routes within a University building.
- Further information about the fire safety arrangements for a particular building.